

商品ID	SKU编码	商品名称	69码	产品型号
24876	NUN4087GL	米家声波电动牙刷 T500 B2B	6934177713095	MES601

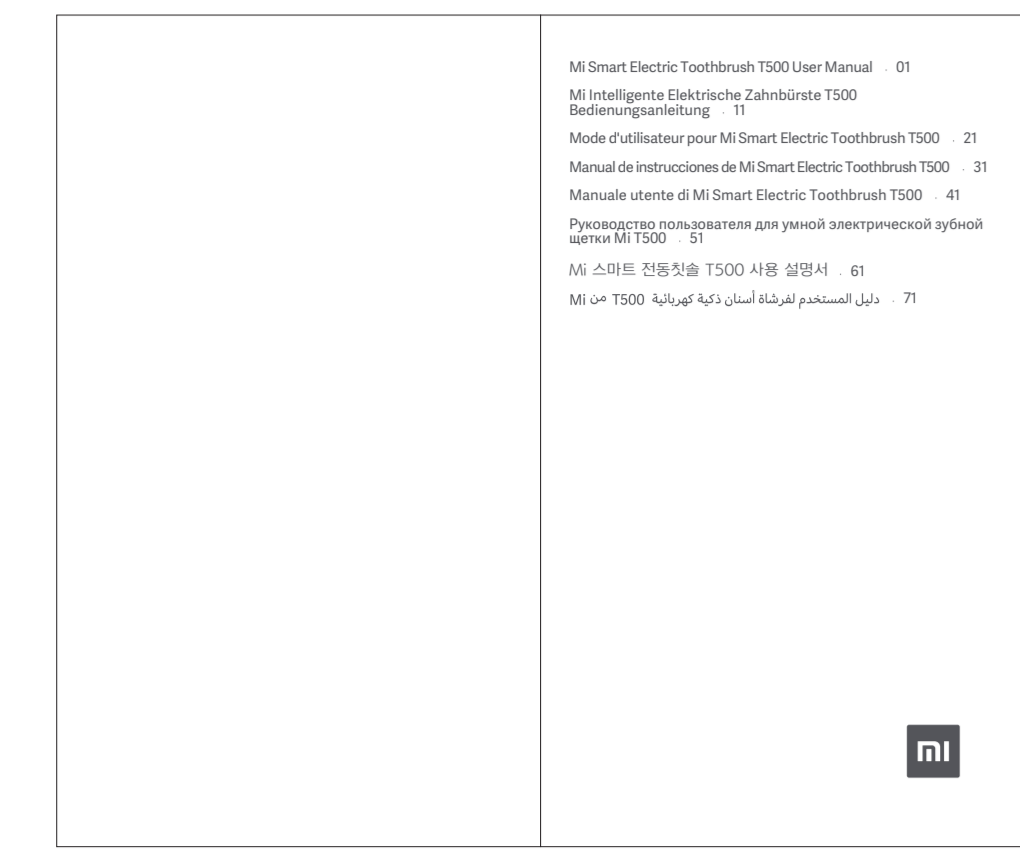

英语

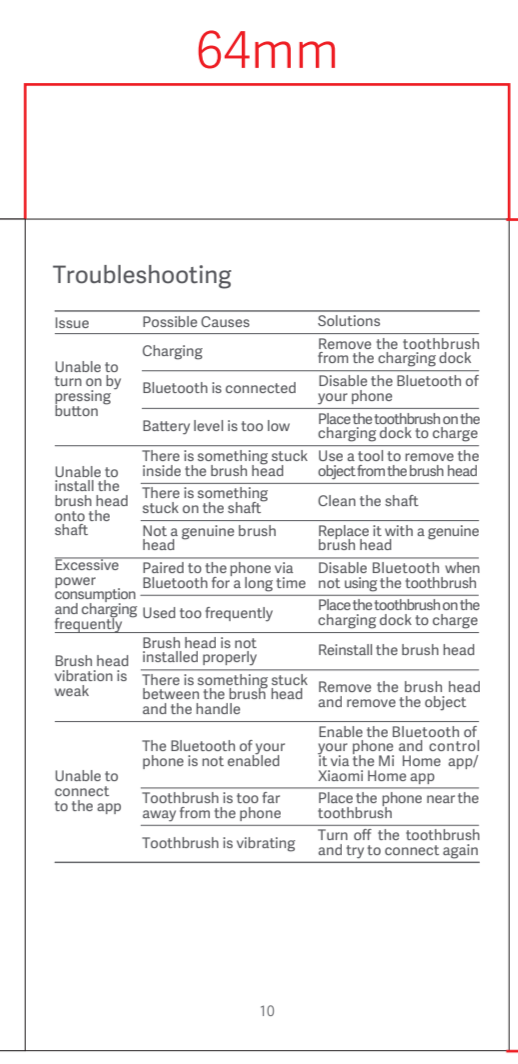
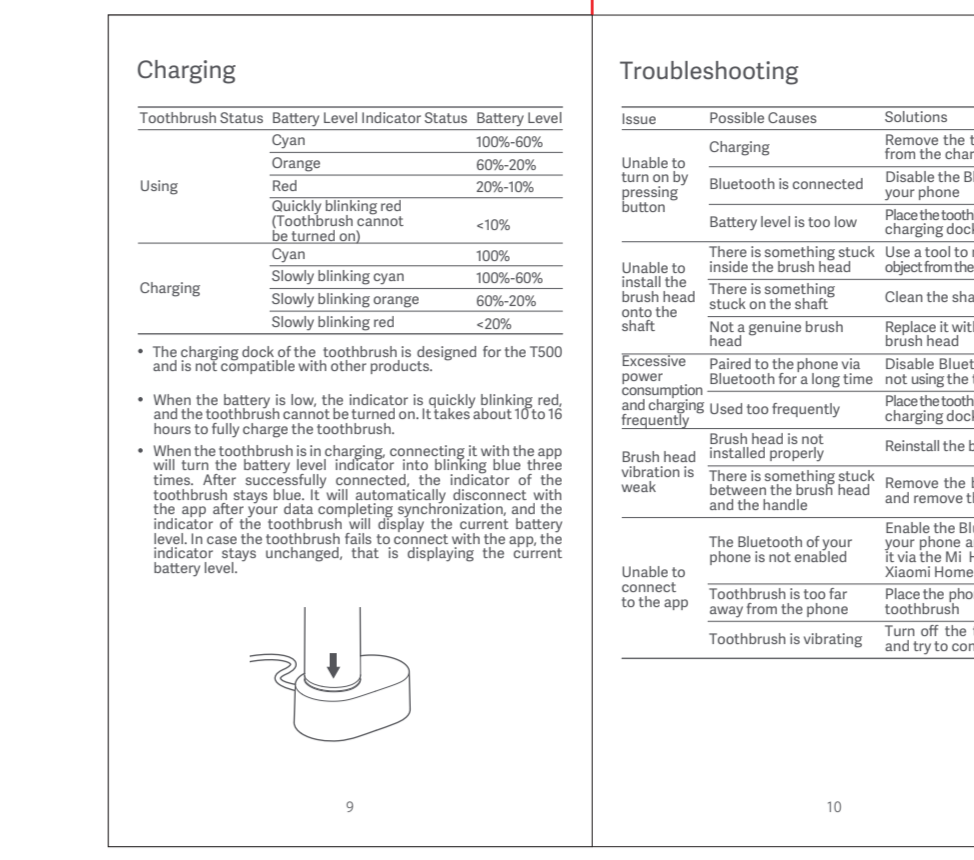
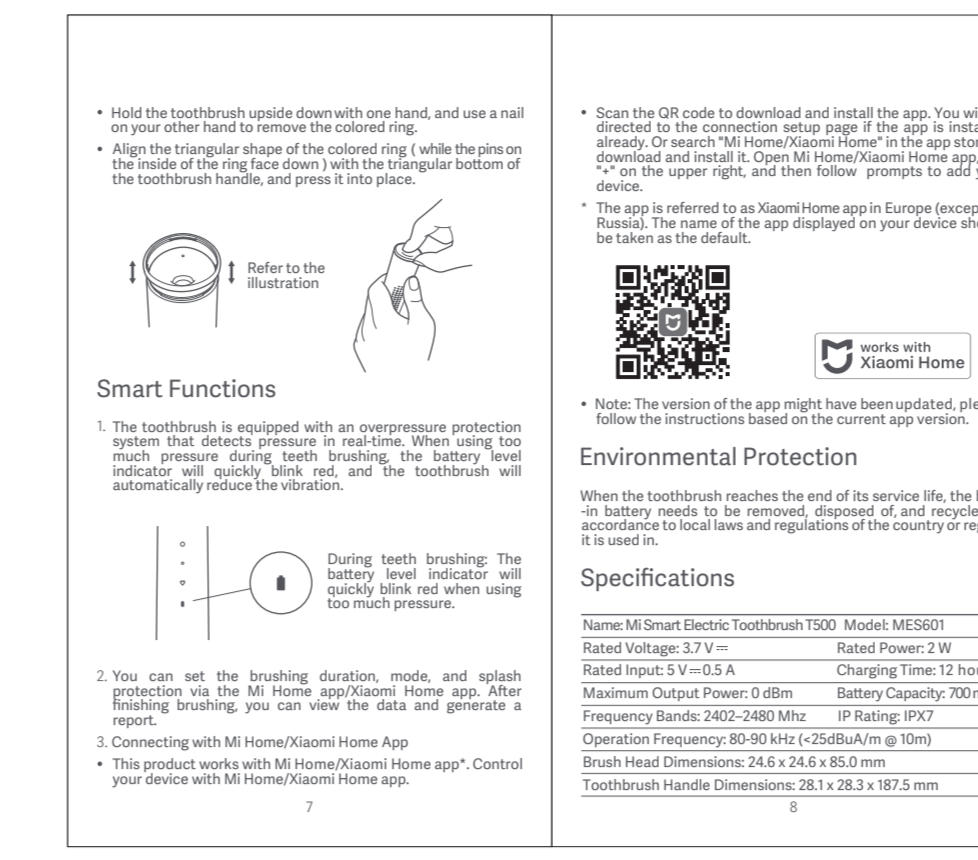
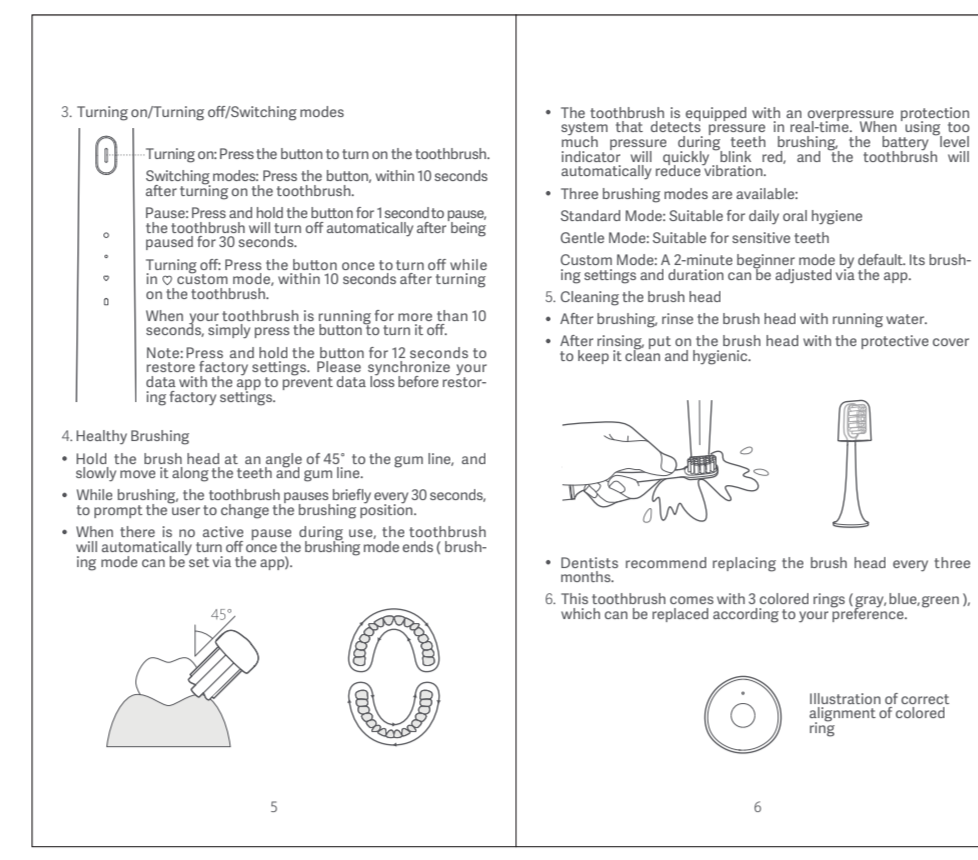
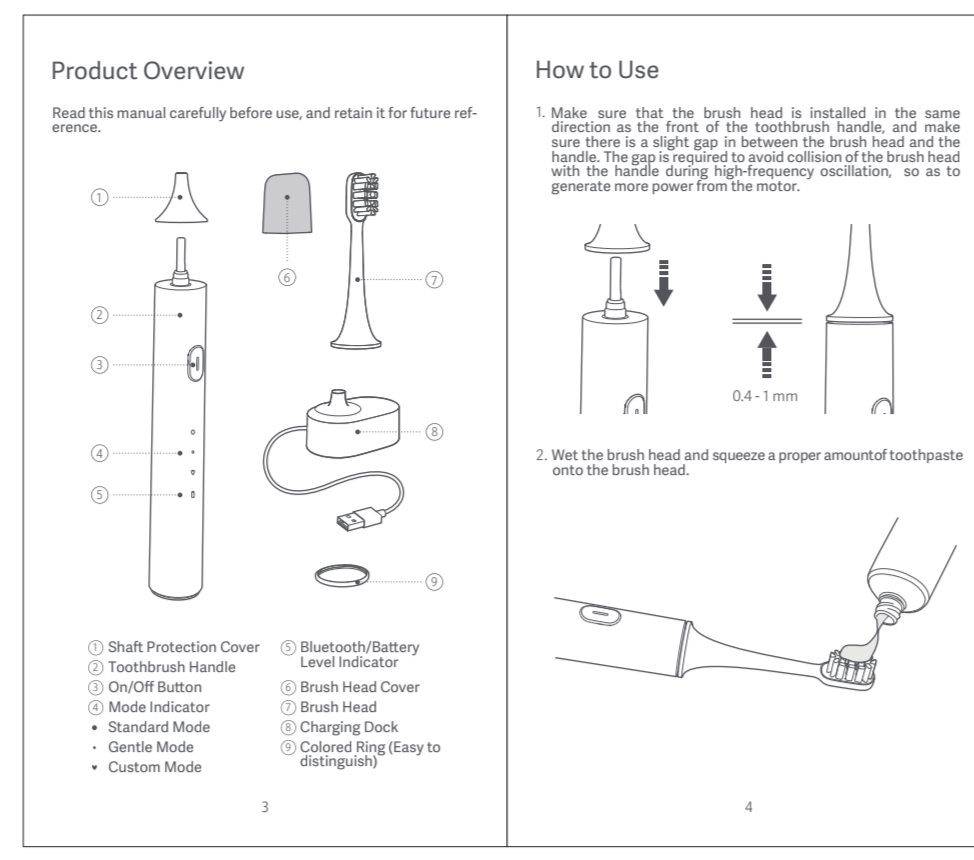
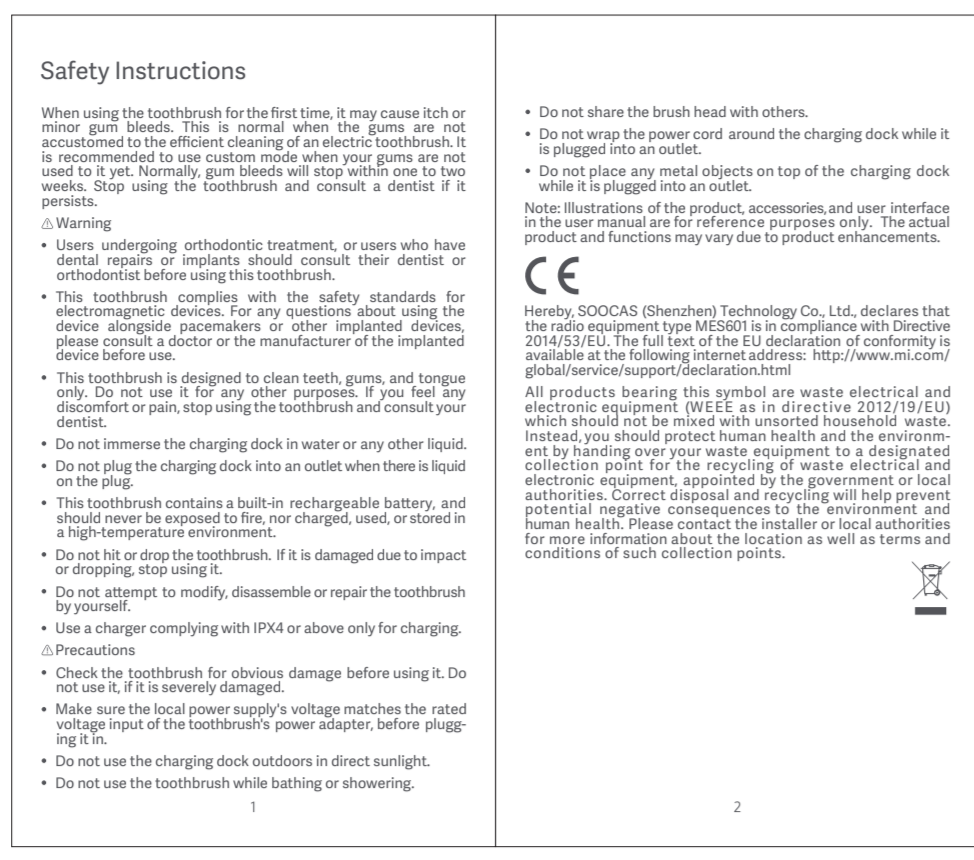

英语

小米生态链产品包装图纸

图纸提供单位

舒可士（深圳）科技有限公司

项目名称
米家声波电动牙刷15分销版 说明书
料号:

版本号
V1.0

设计时间
20190820

设计师
冯光禄/邹敏

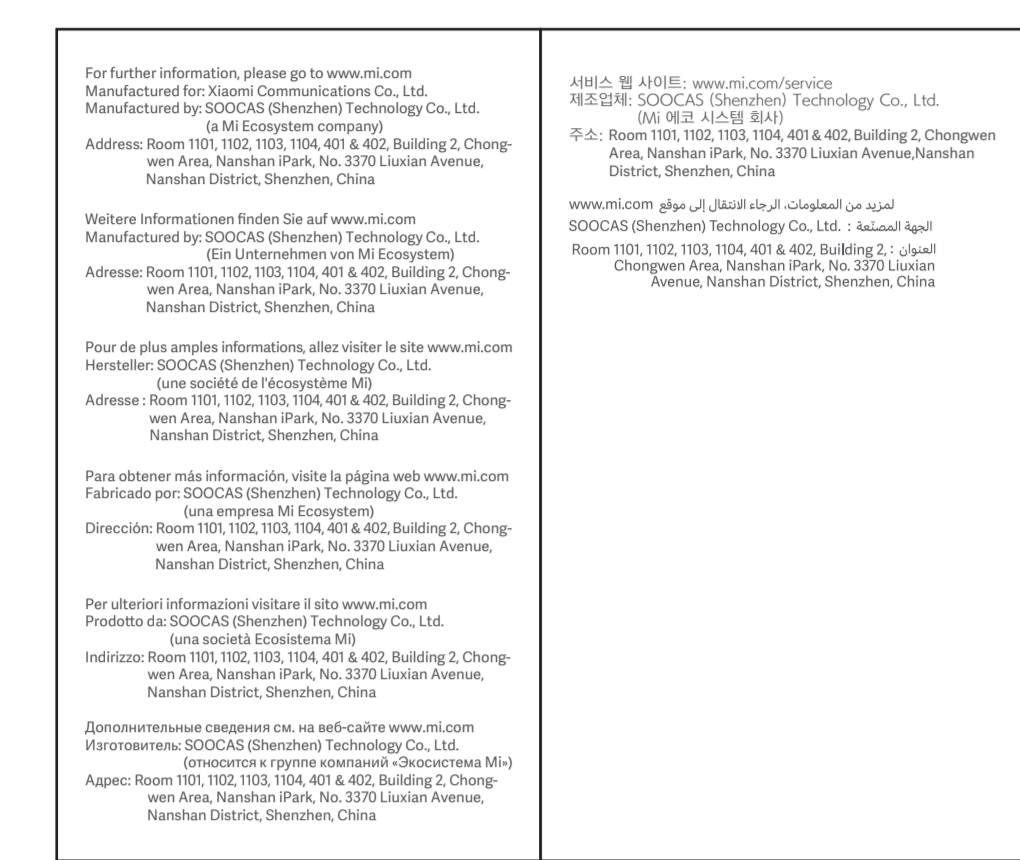

封底

德语

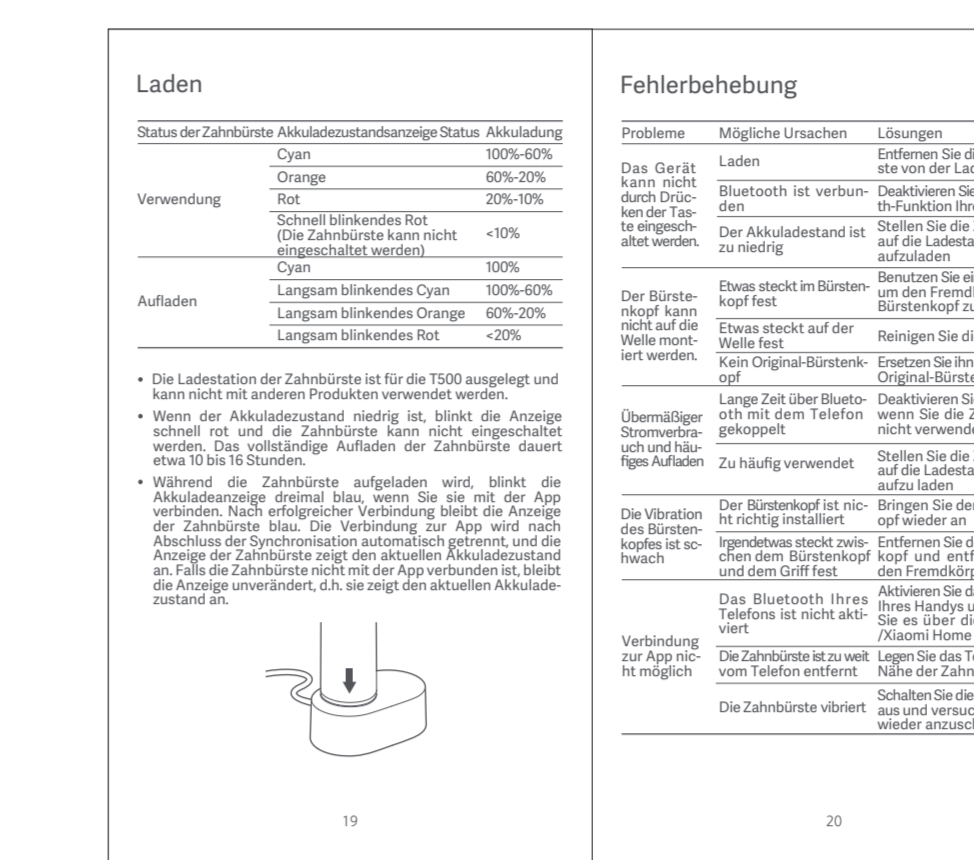
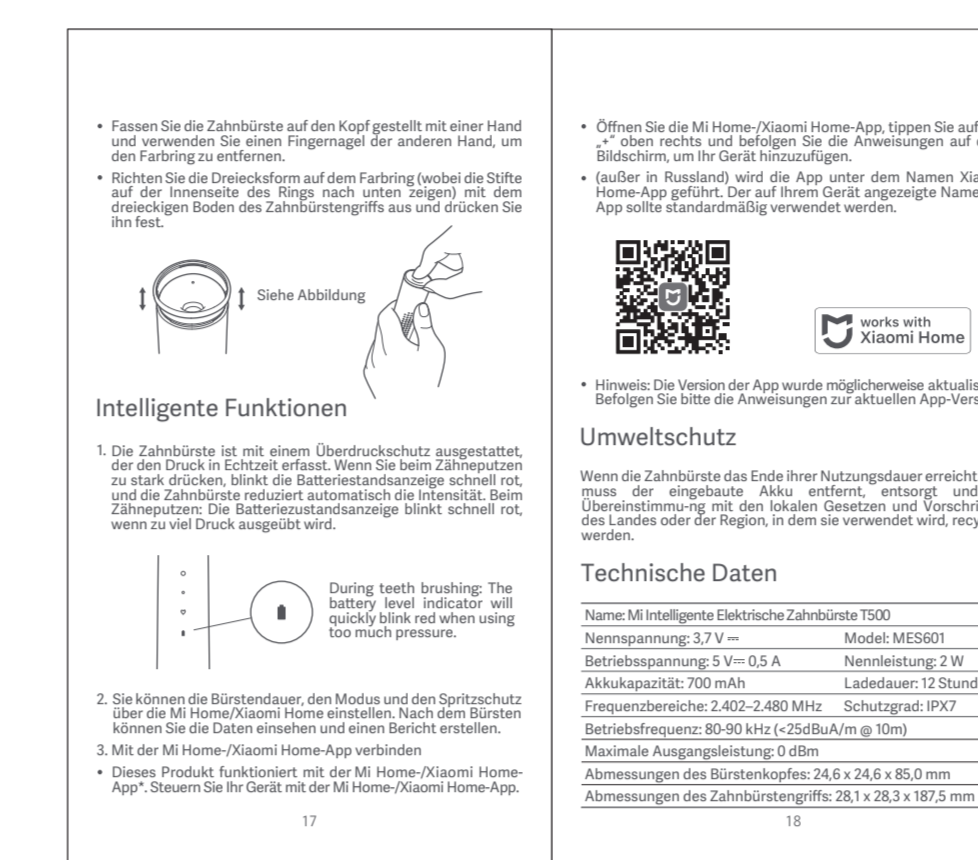
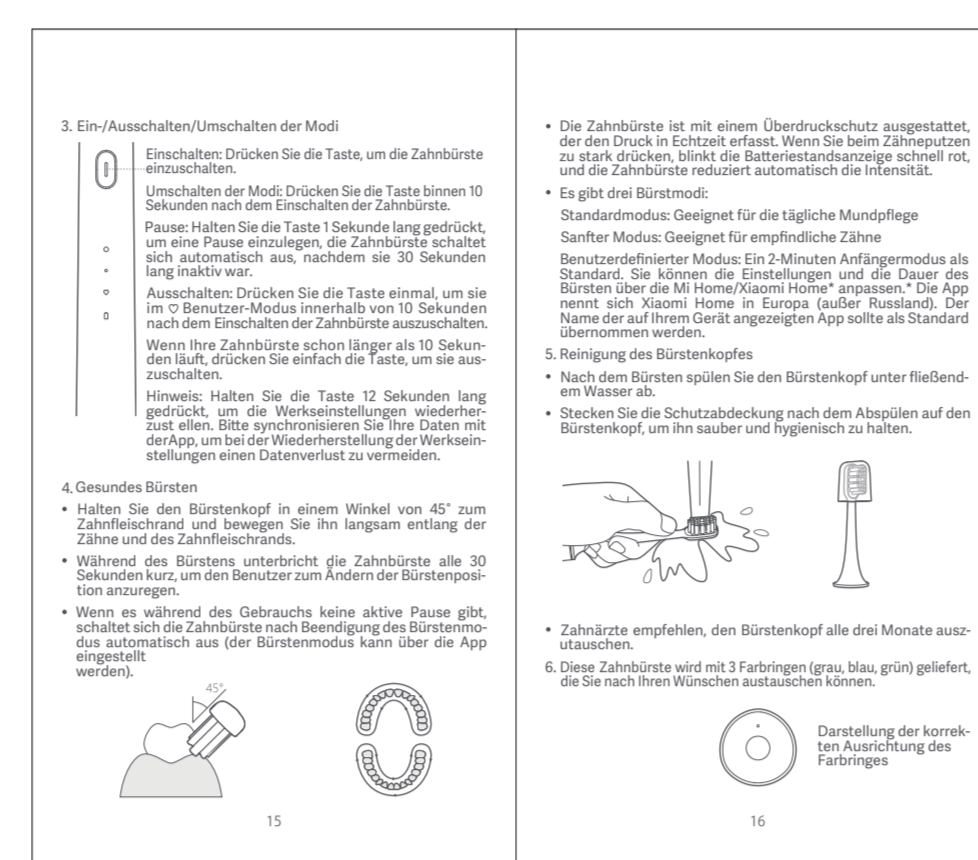
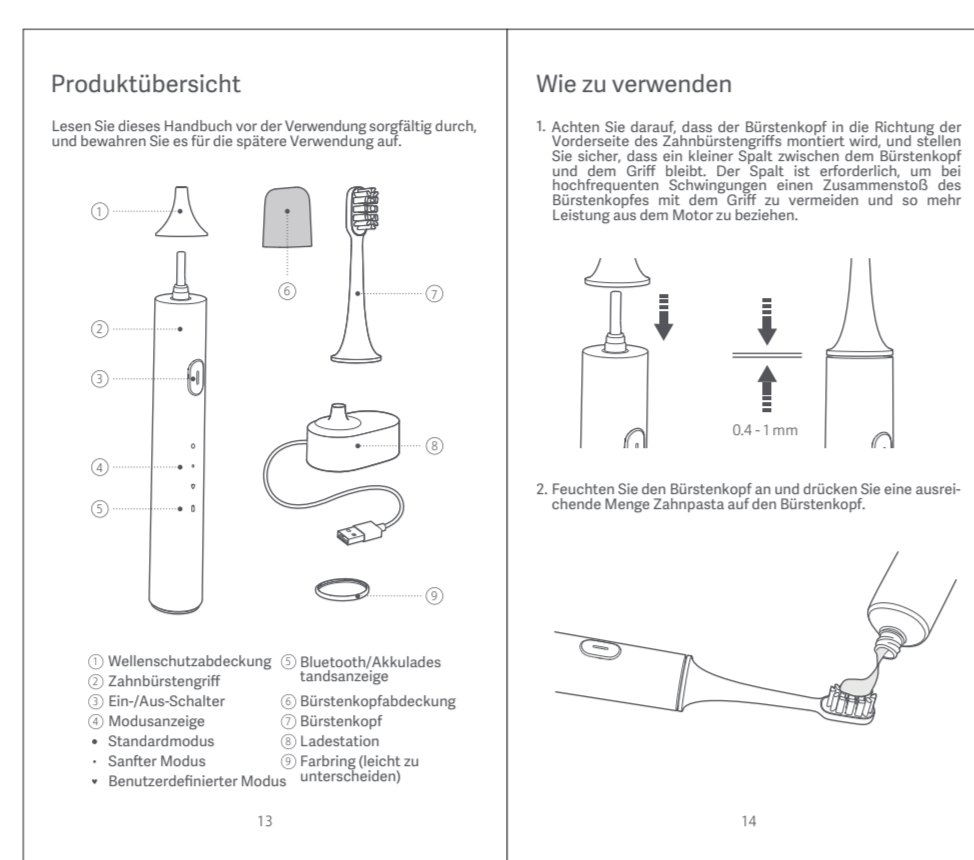
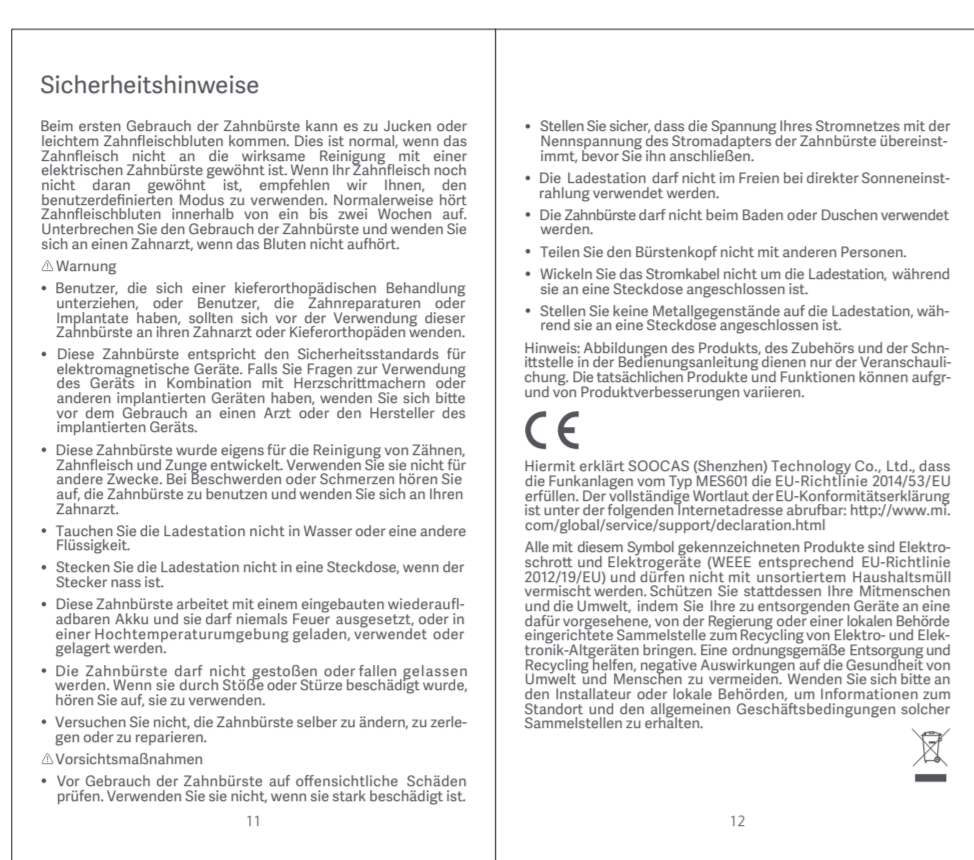

德语

材质要求: 材质: 金东太空模105G无光铜板纸 双面印刷
尺寸: 64*110mm 84P 胶装

制作工艺: 专色印刷+哑PP+啤切

工艺要求: 色相正确、印迹牢固、套印准确、各色套印不露杂色、套印误差≤ 0.1mm

颜色及专色: Pantone Cool Gray 11 C



法语

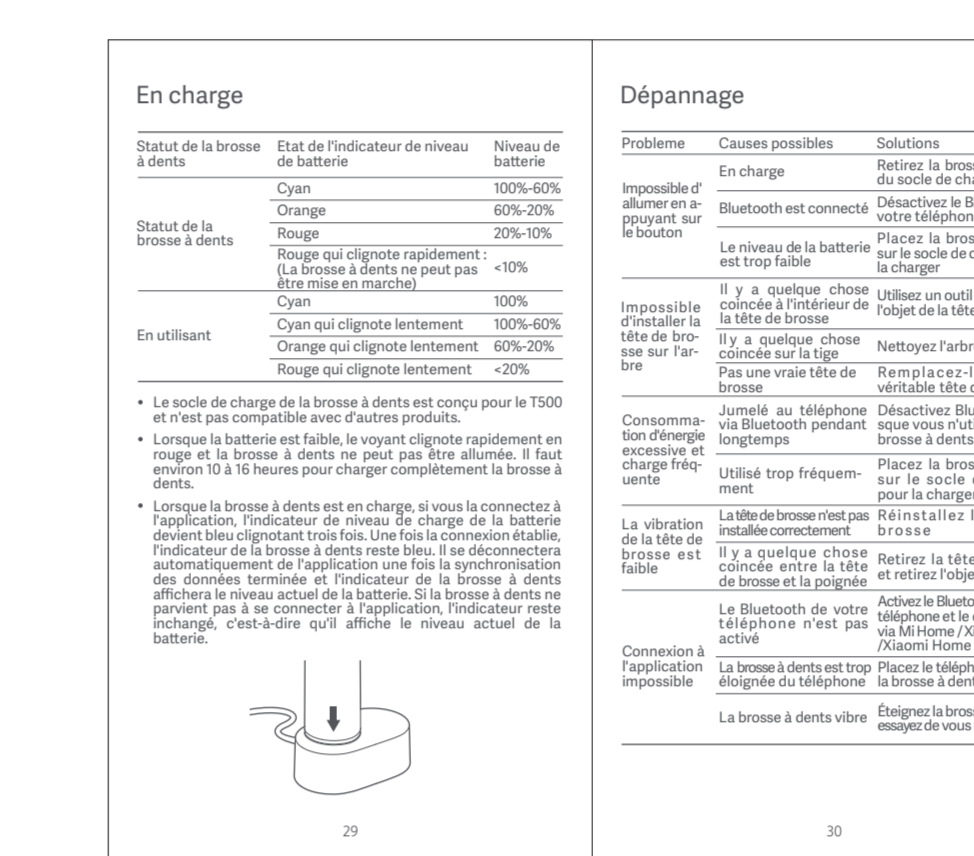
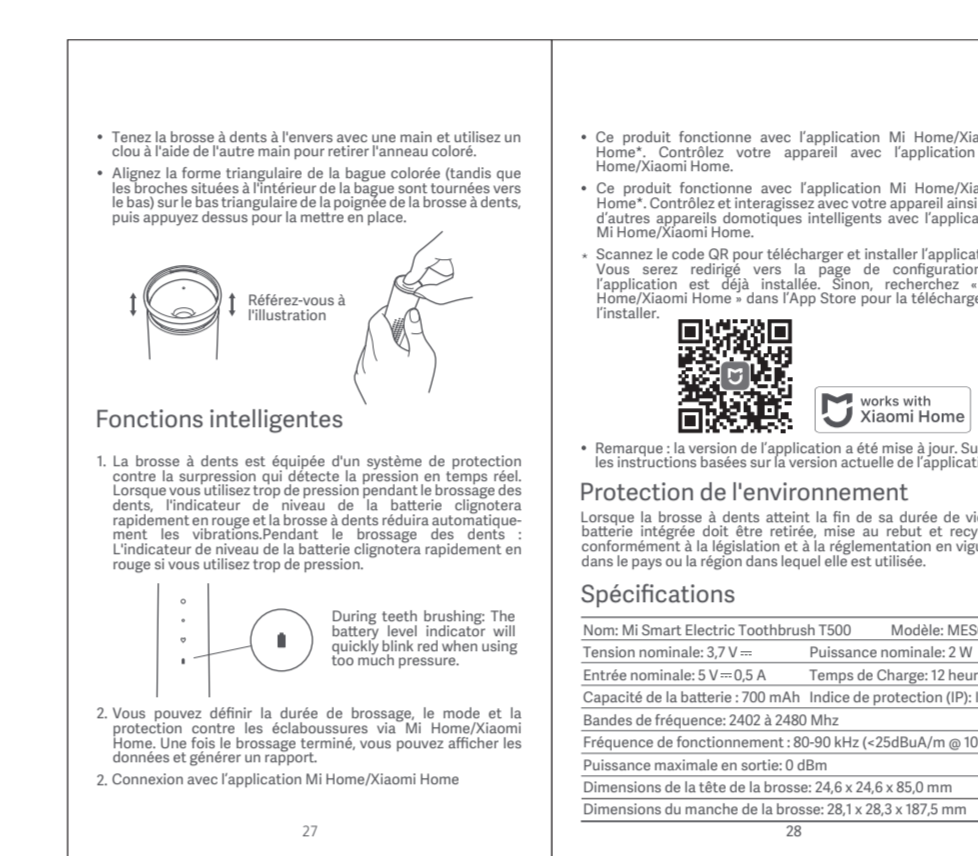
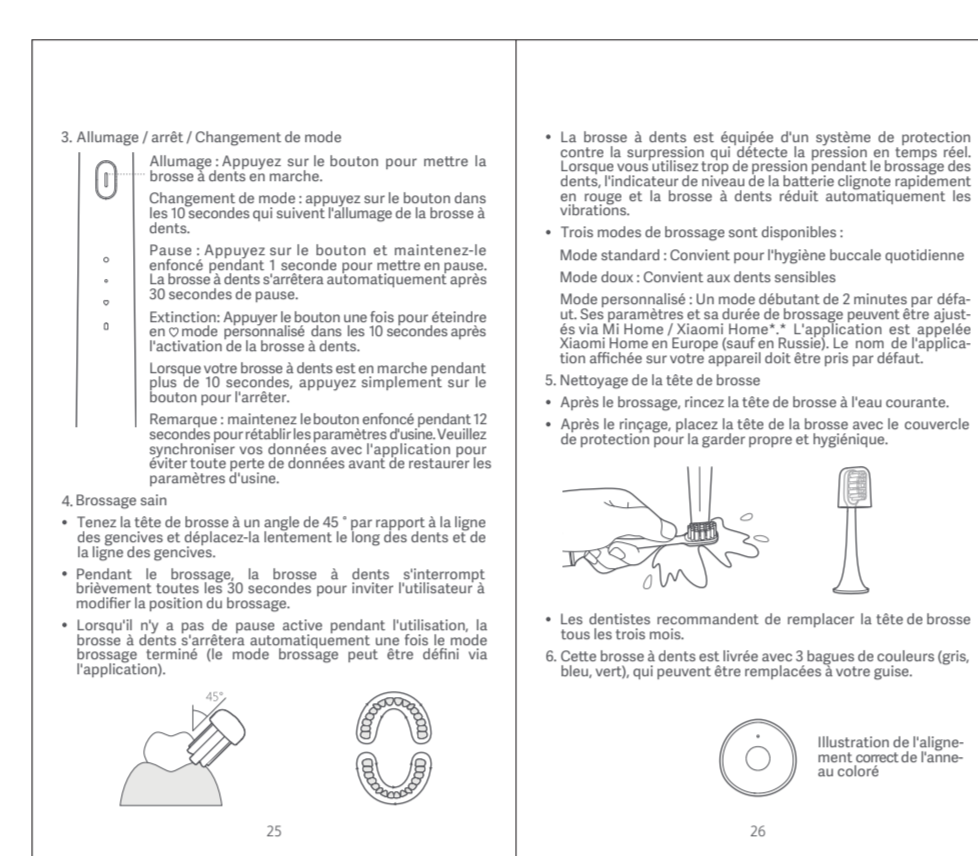
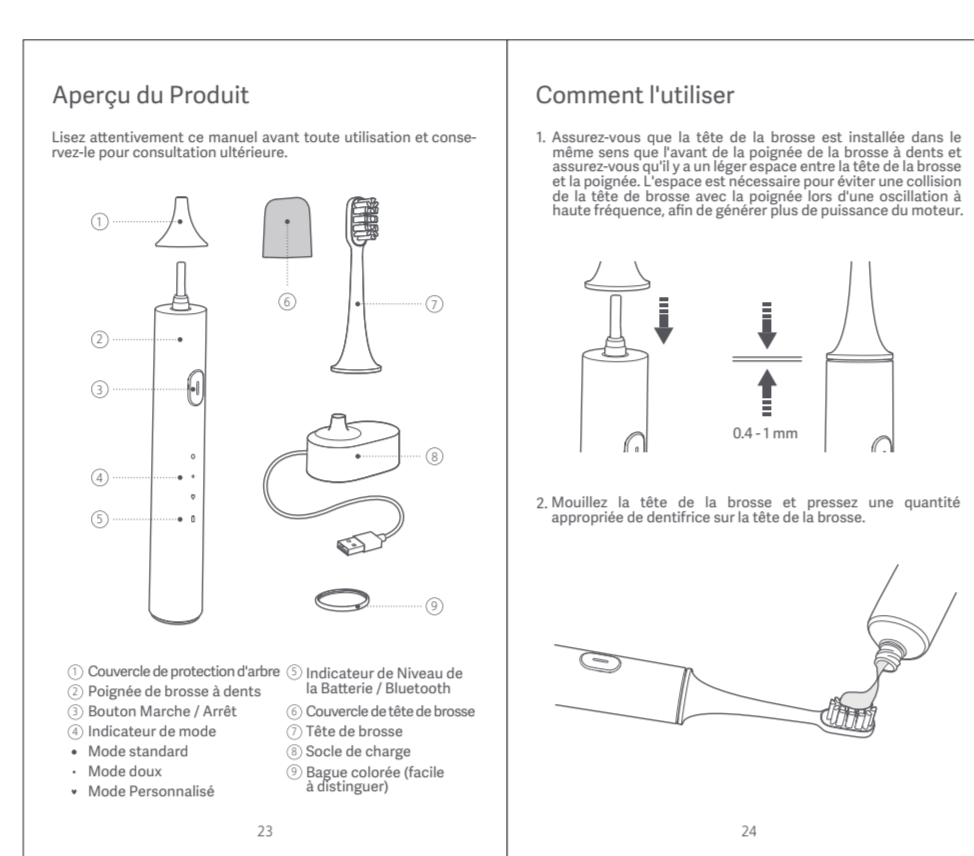
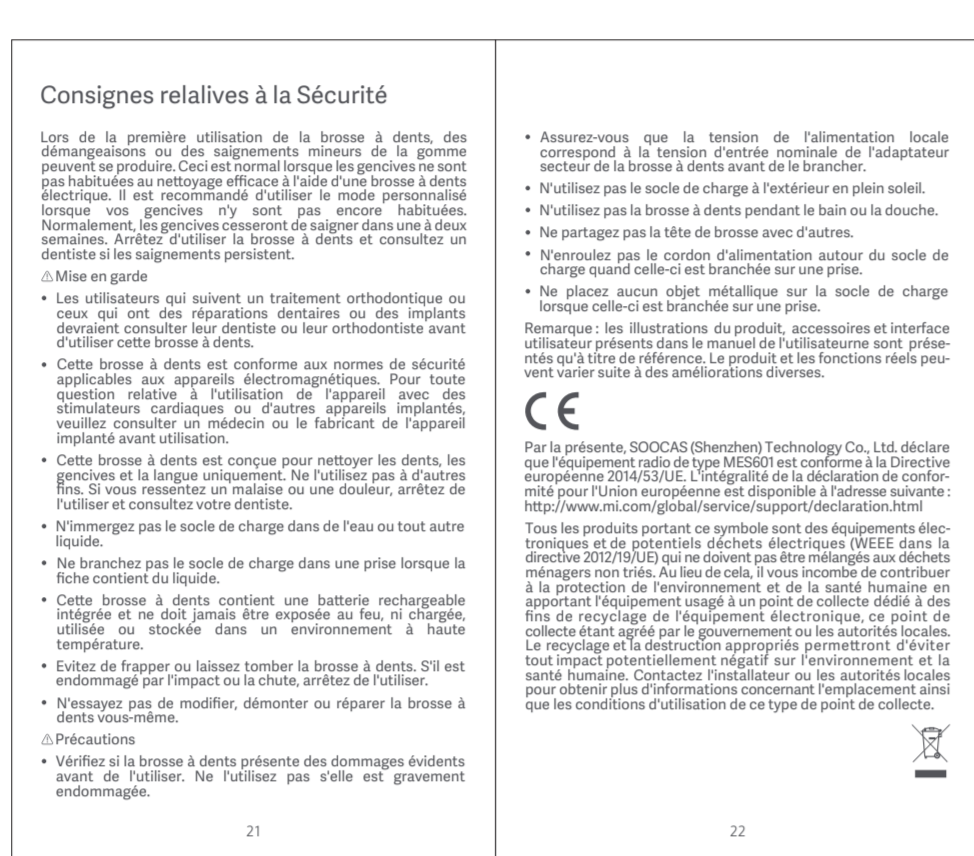

法语

收理要求

纹理方向

如有其它特殊要求, 请写明

比例 1:1 单位 mm

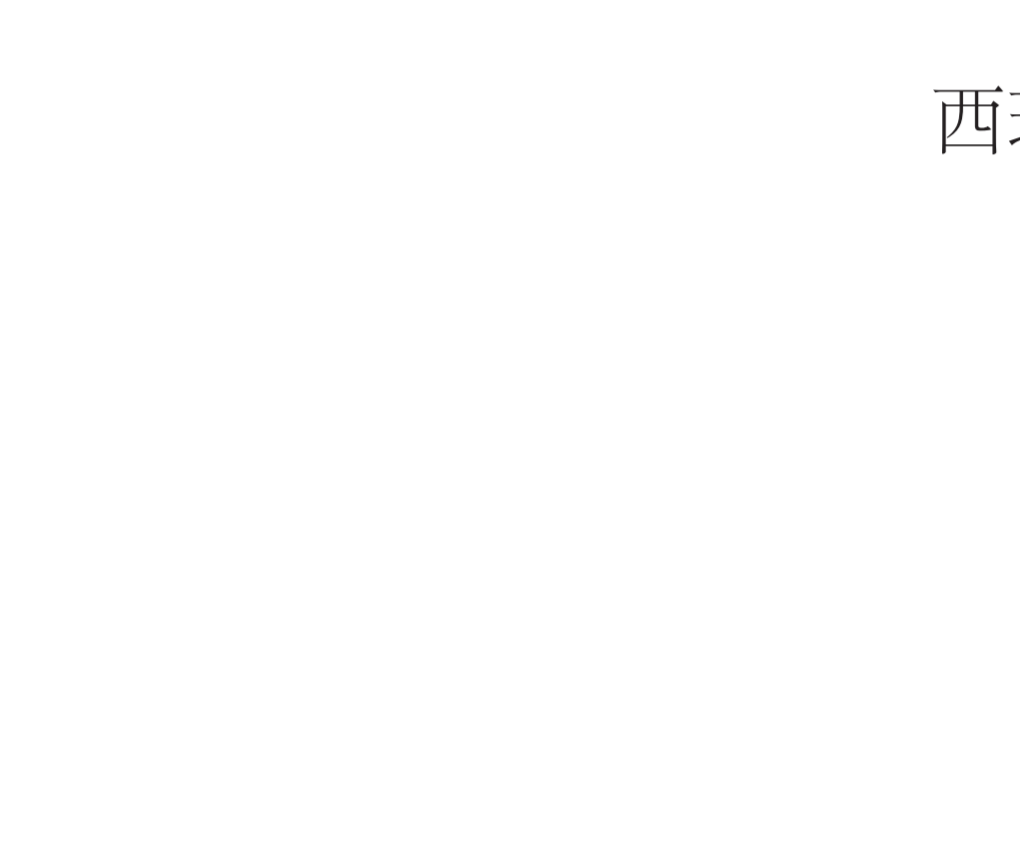

西班牙语

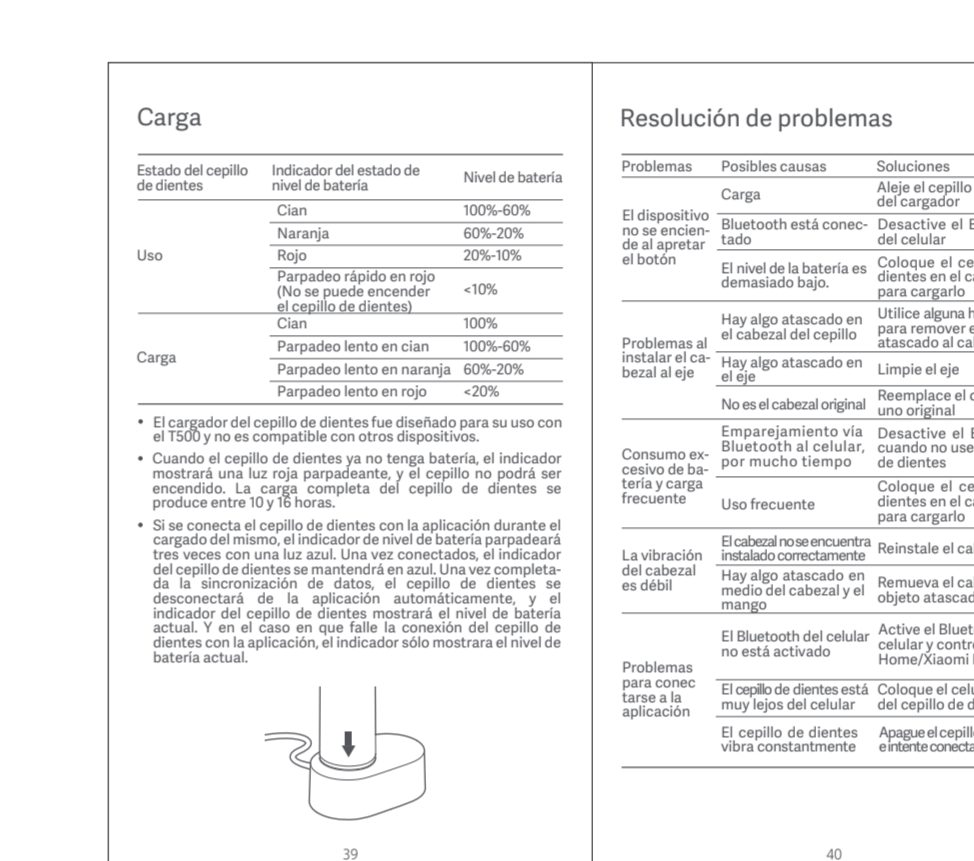
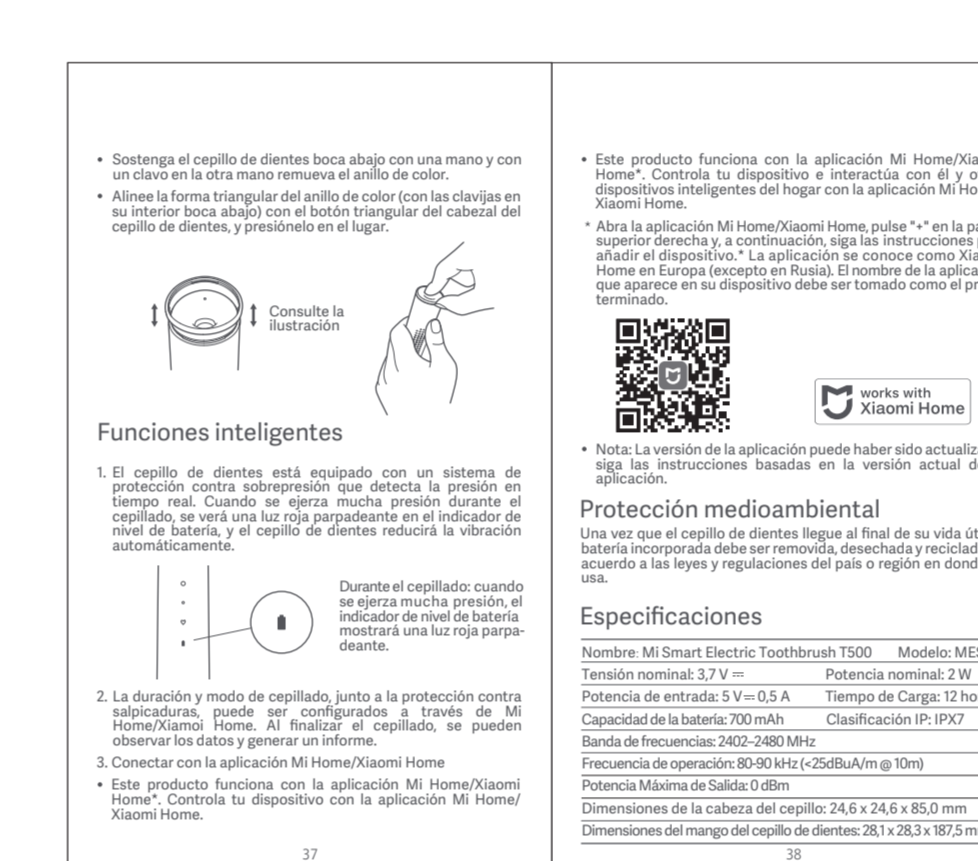
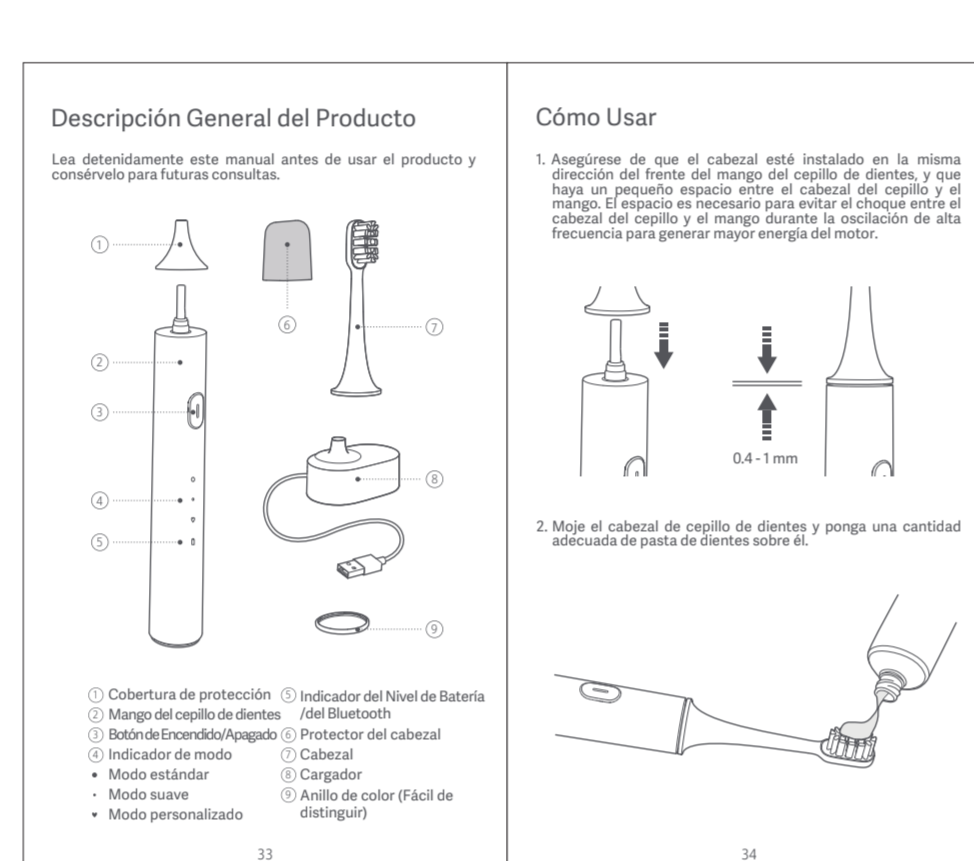
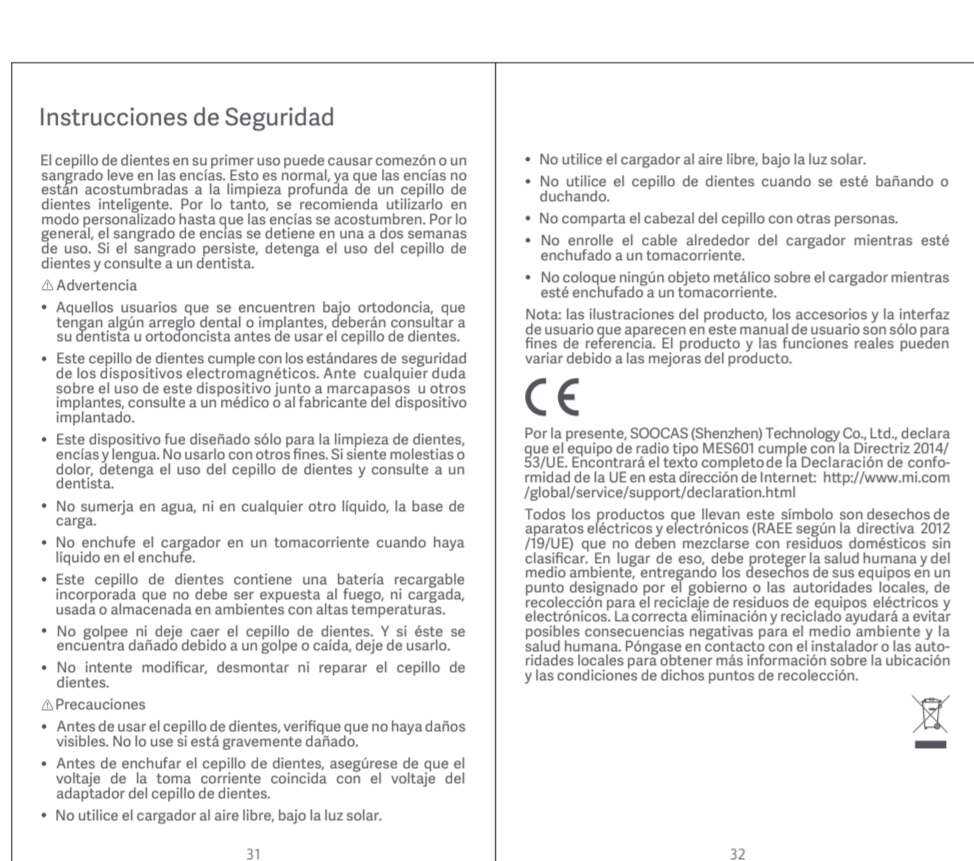

西班牙语

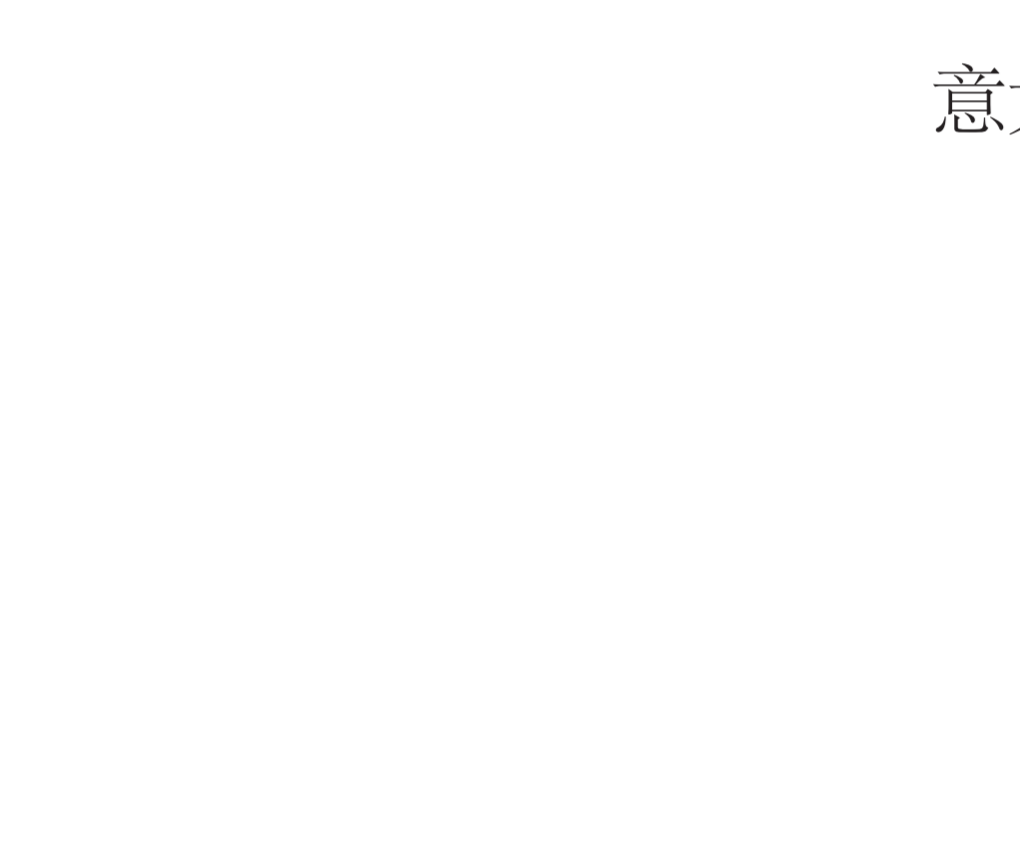

意大利语

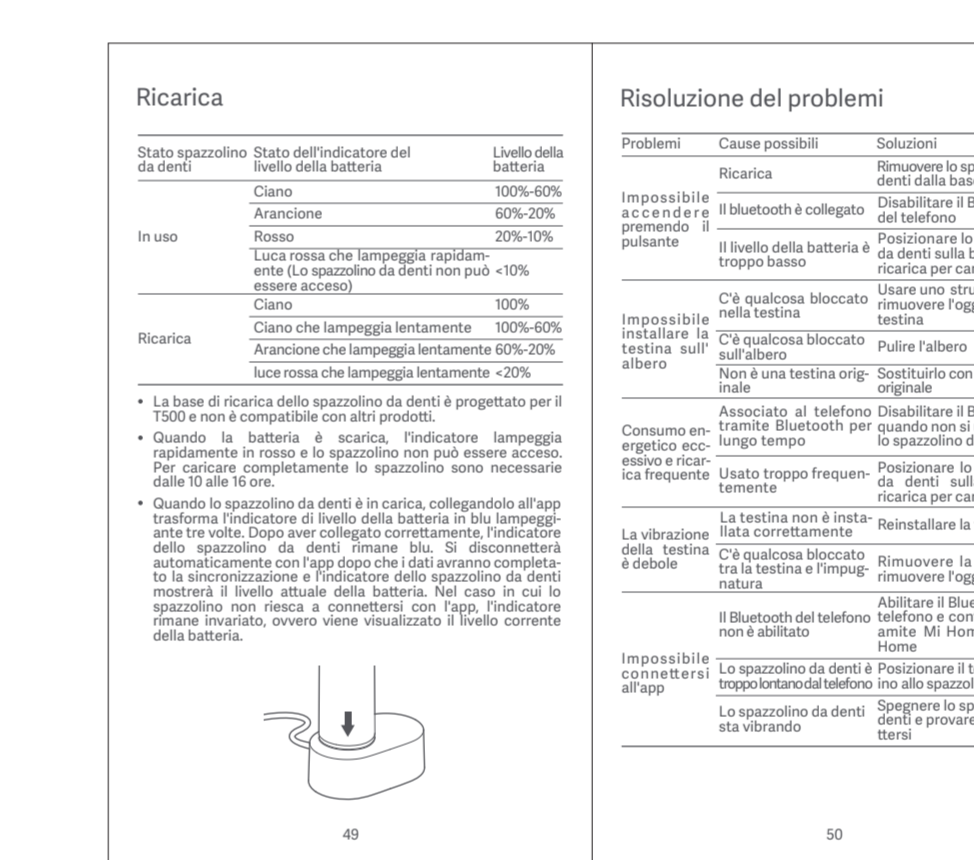
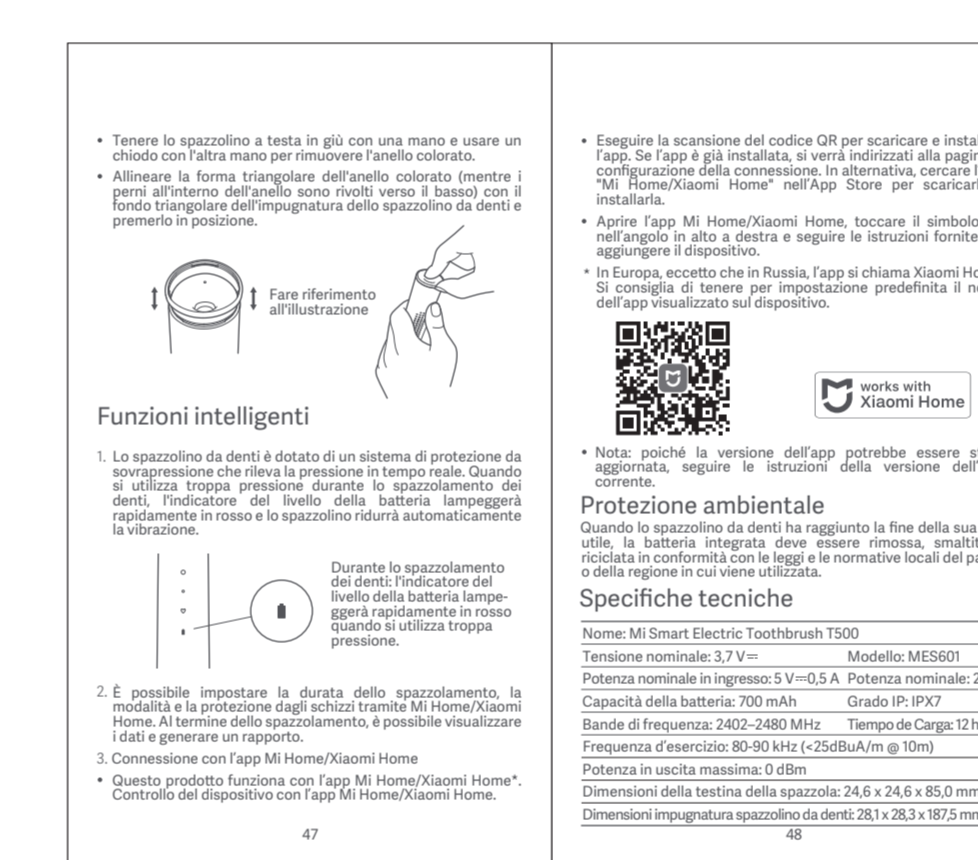
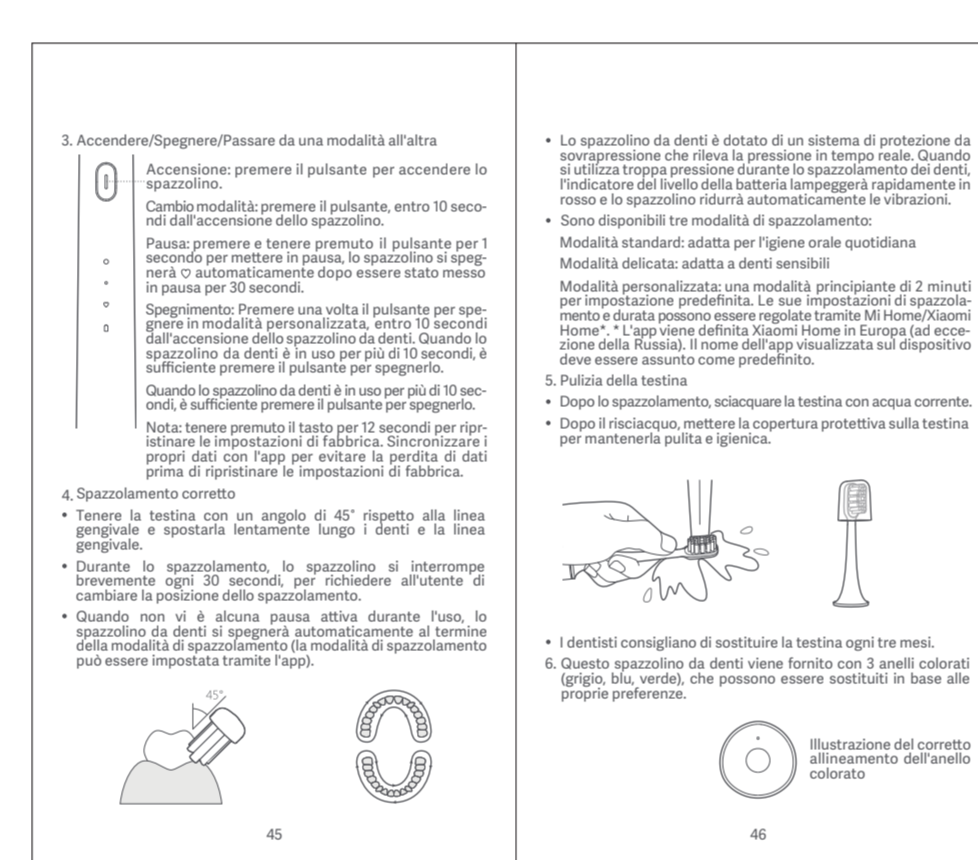
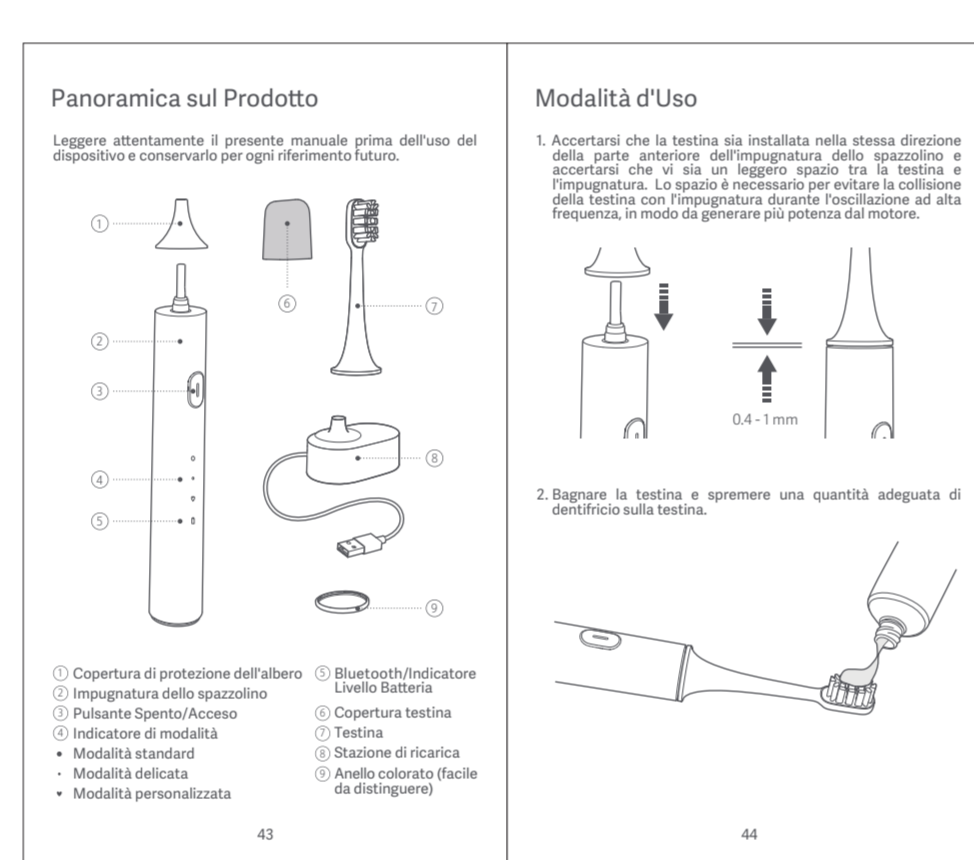
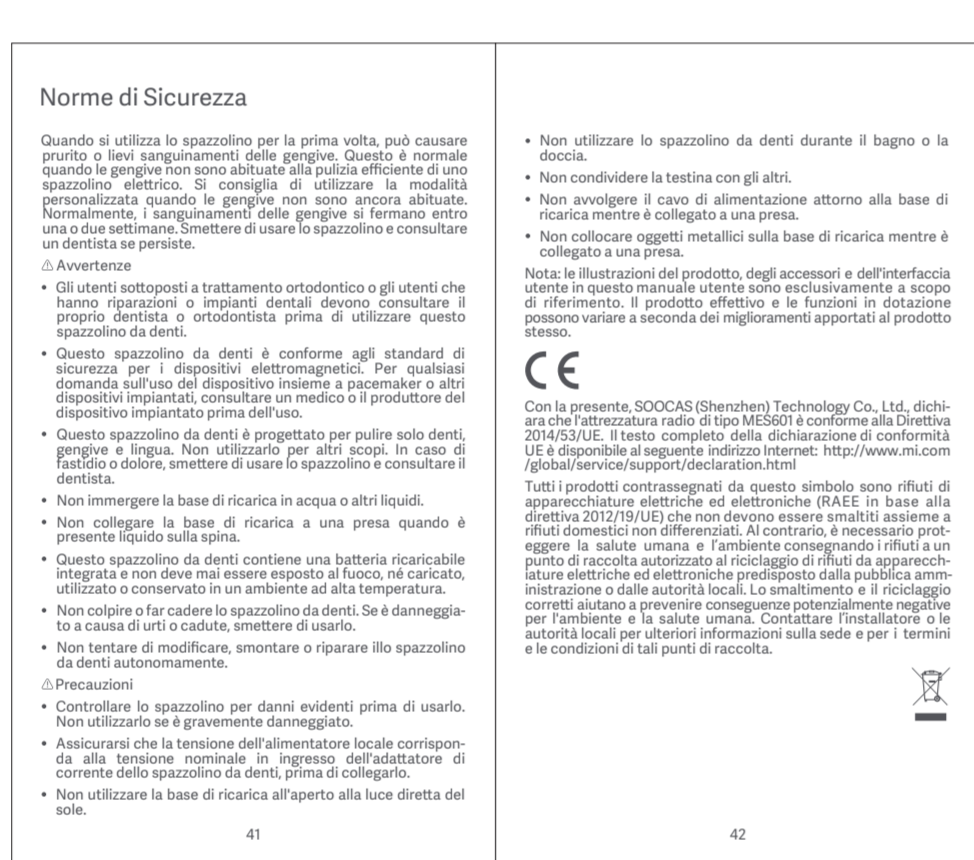

意大利语



俄文

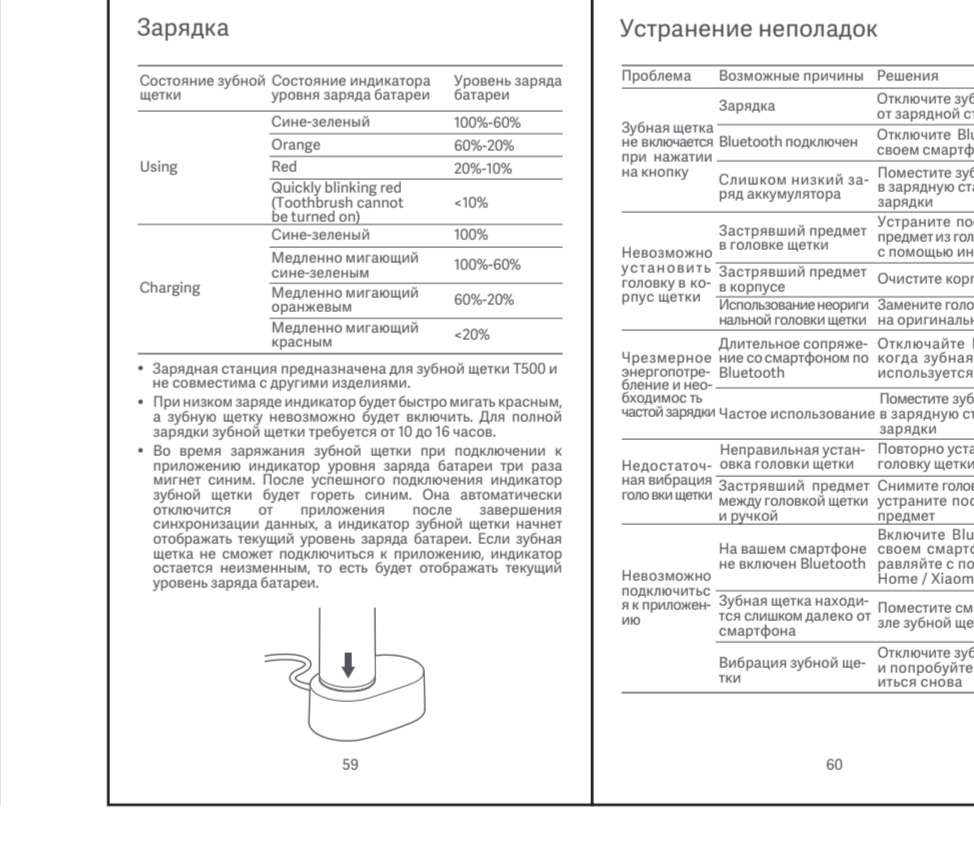
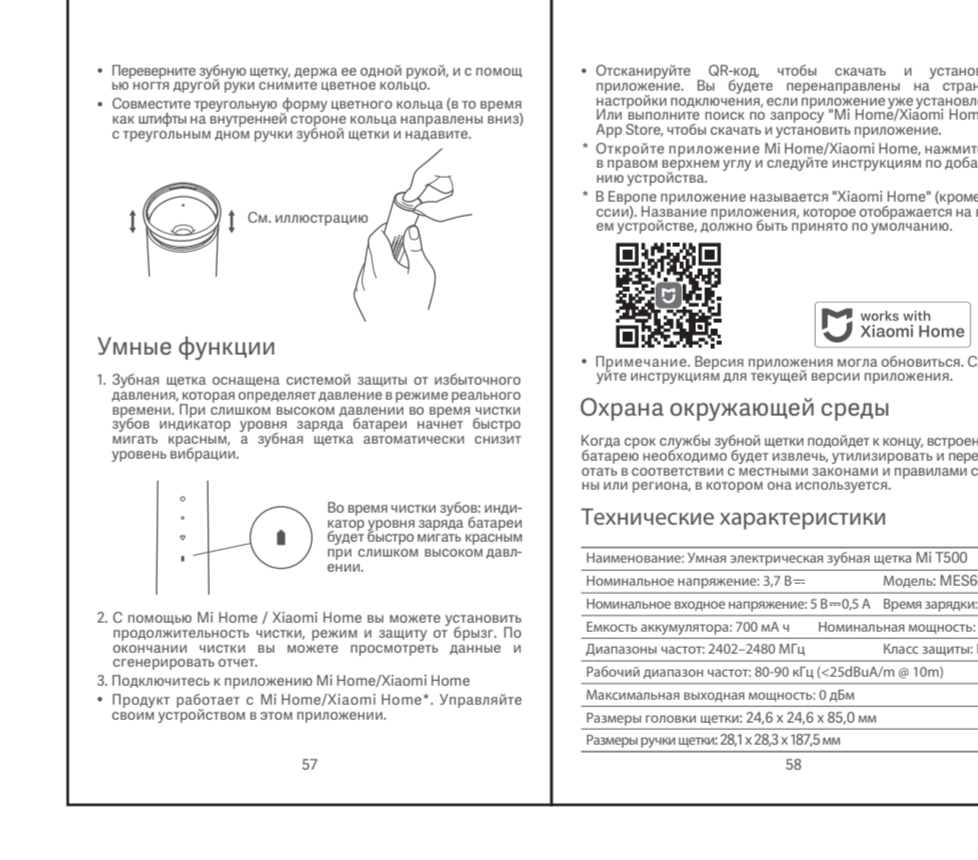
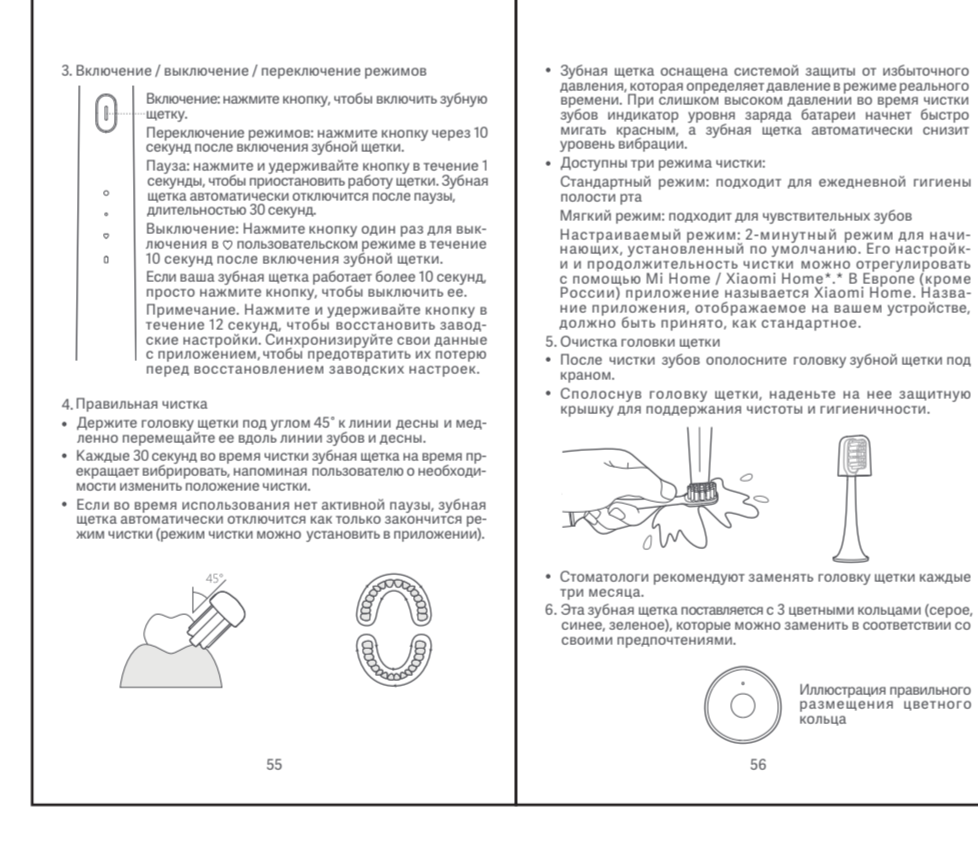
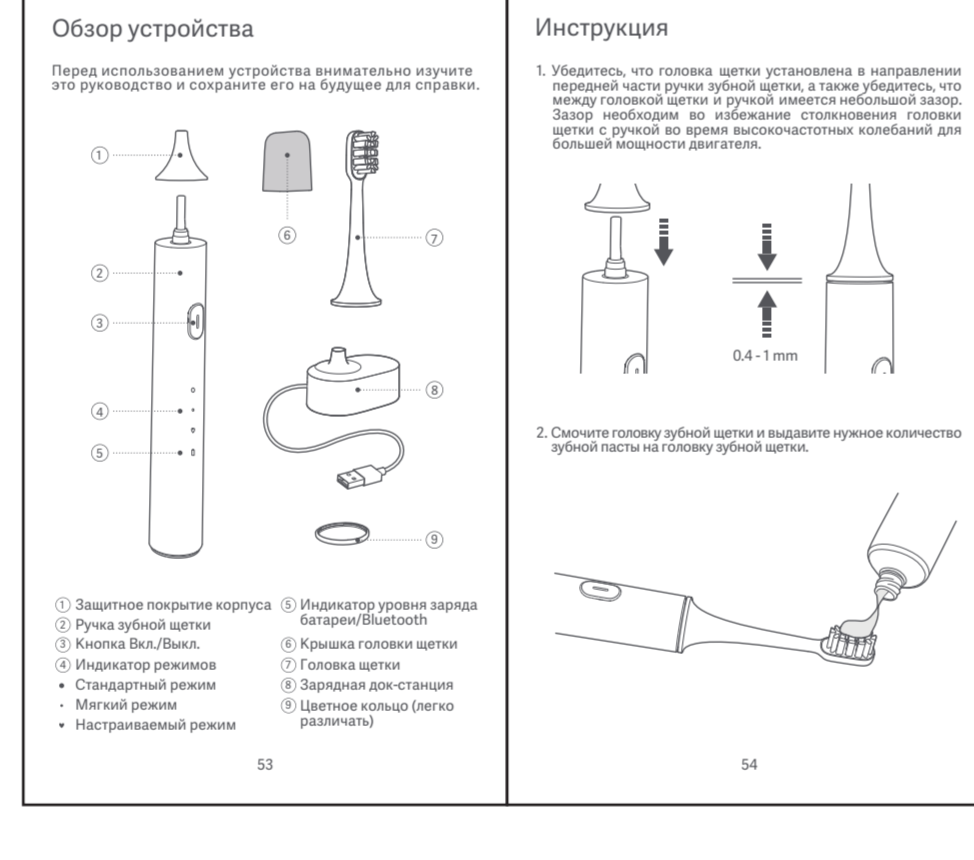
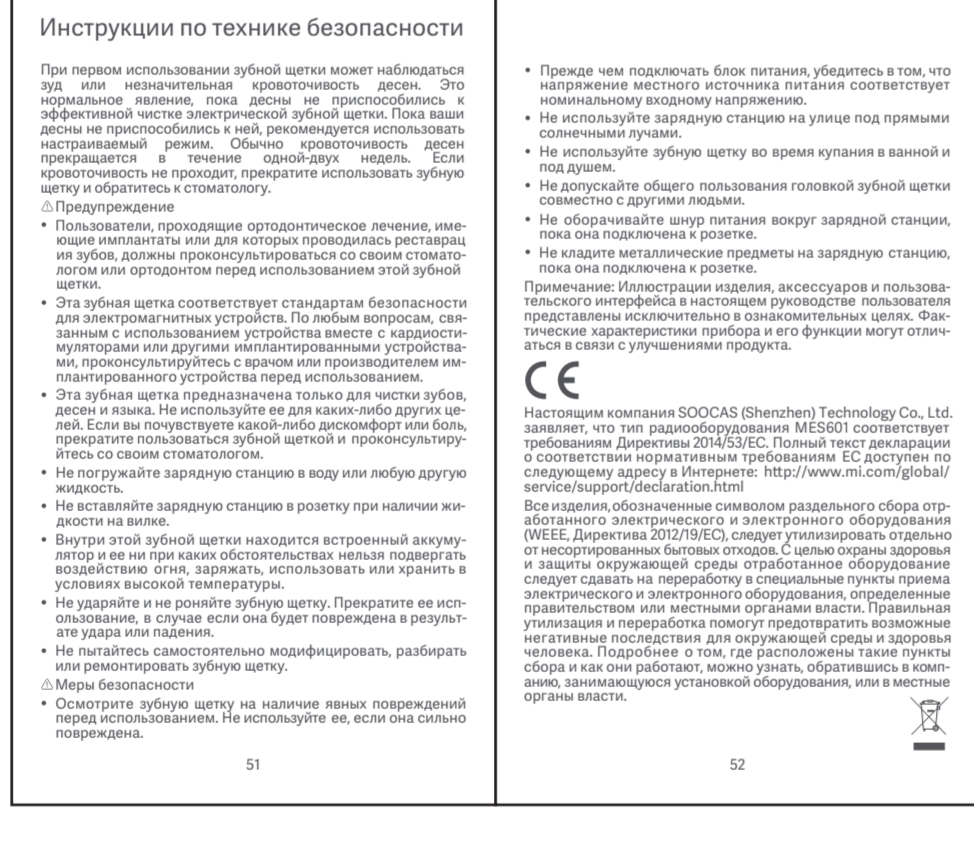

俄文



韩文

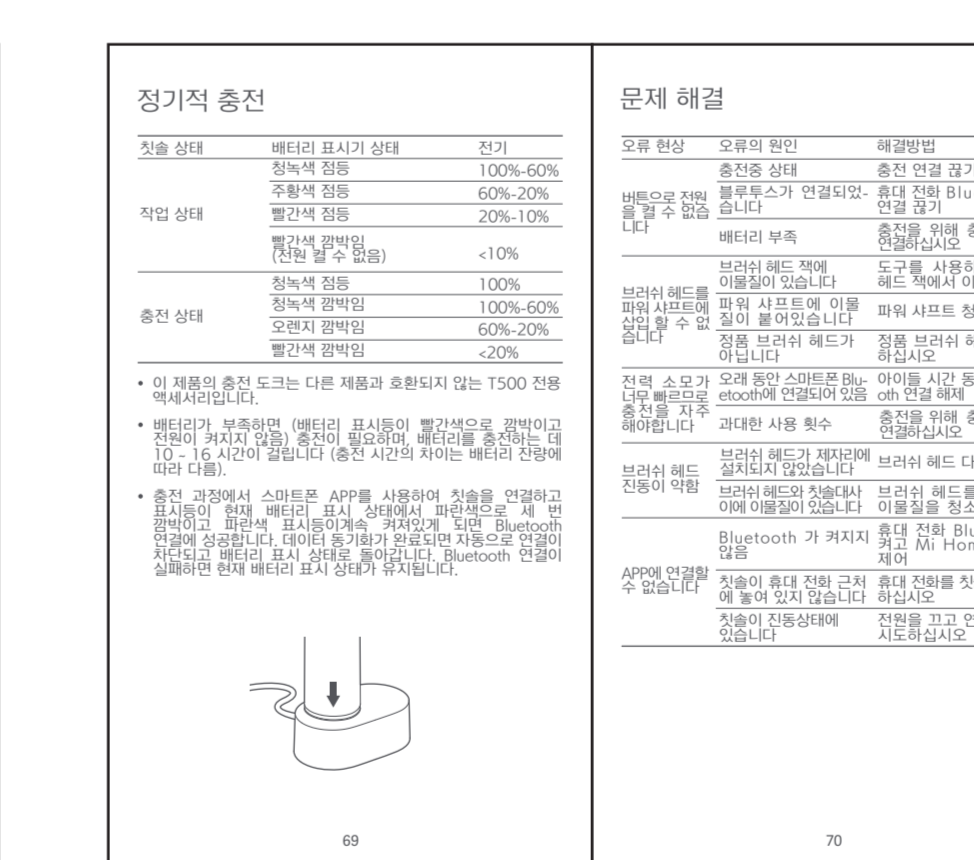
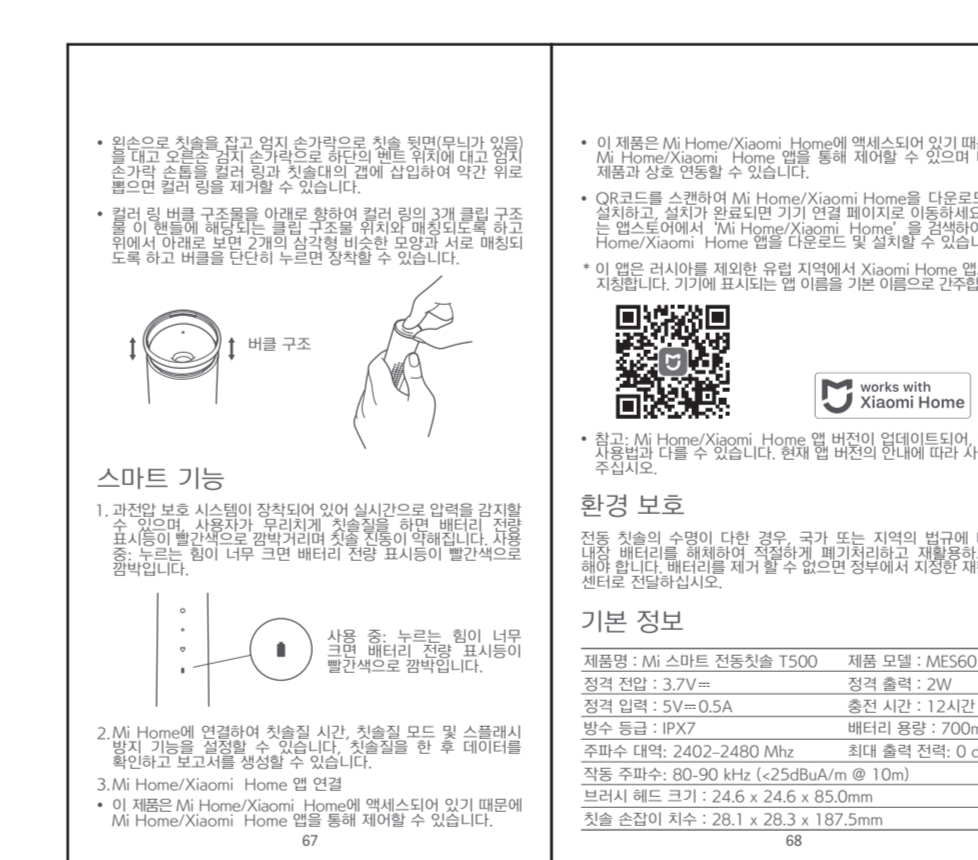
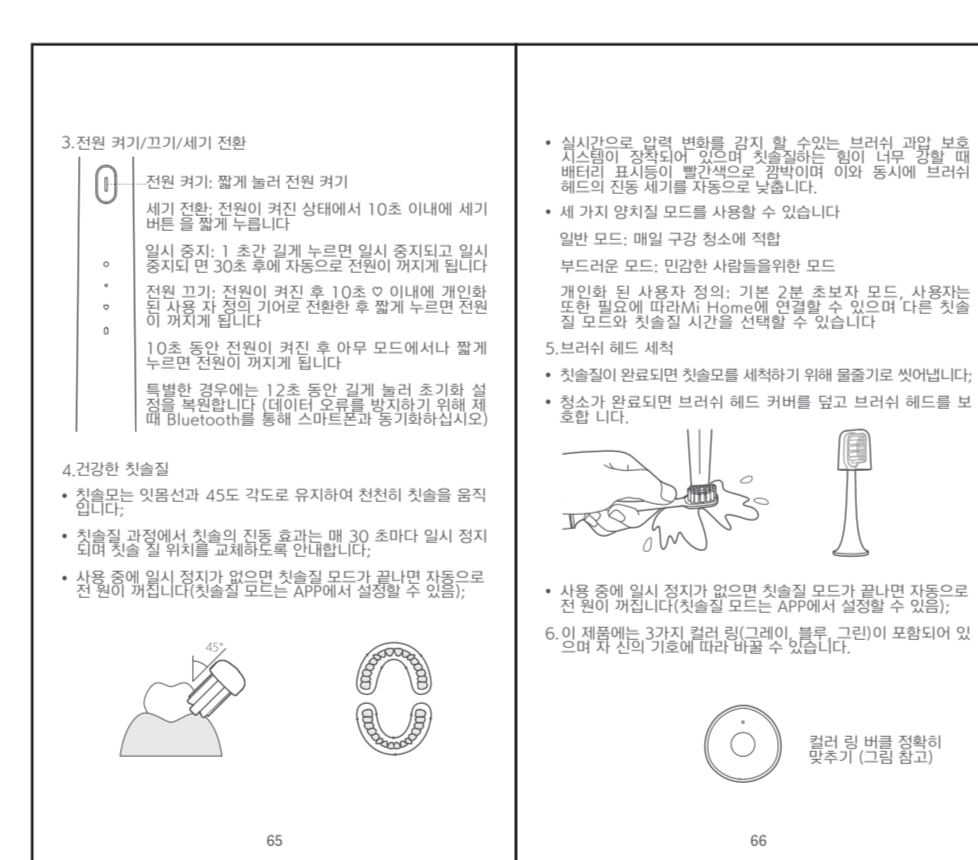
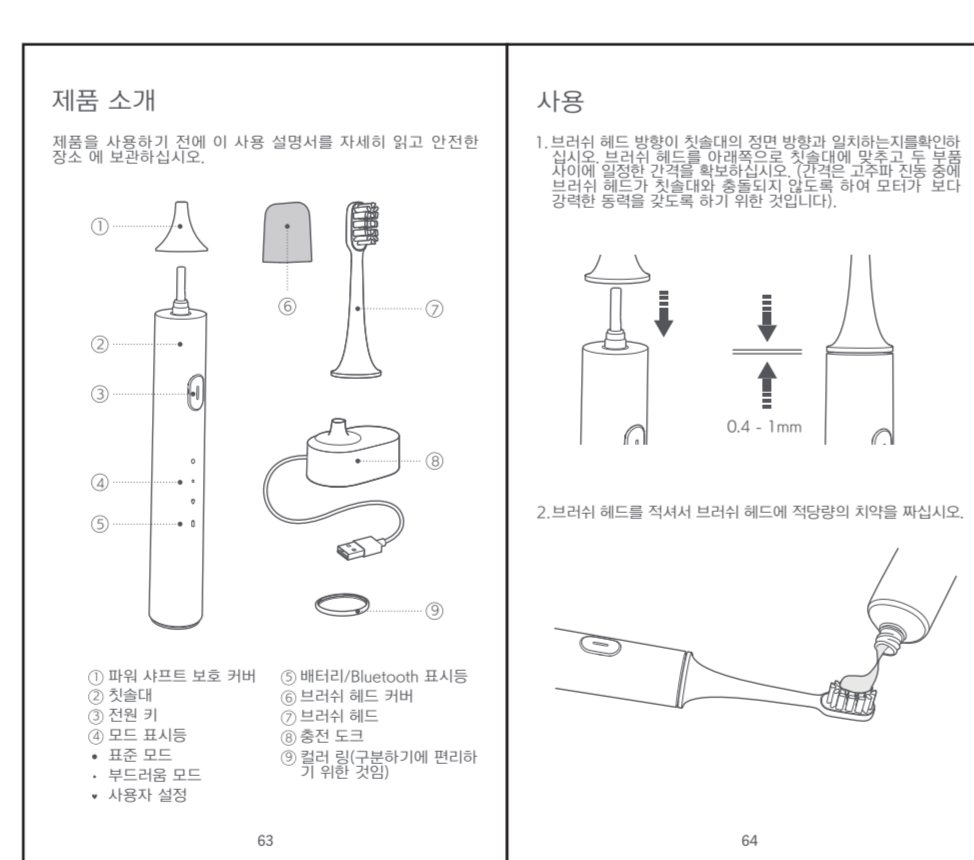
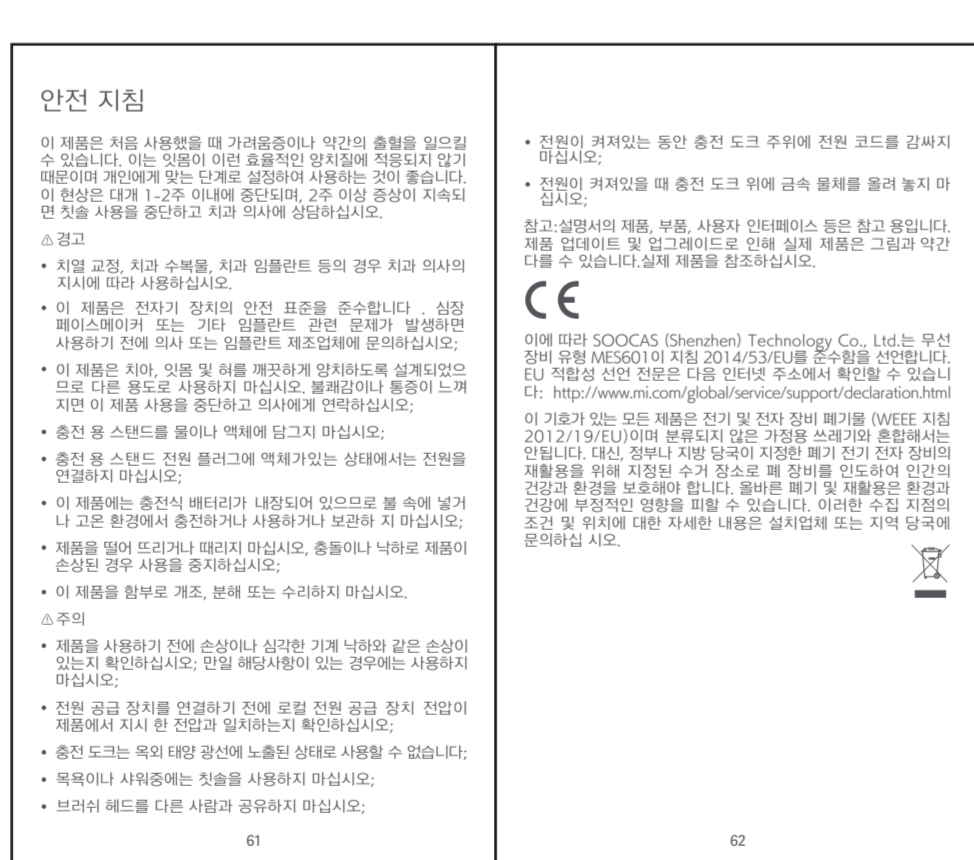

韩文

- 全穿刀
- 压线
- 半穿刀

阿拉伯文正确

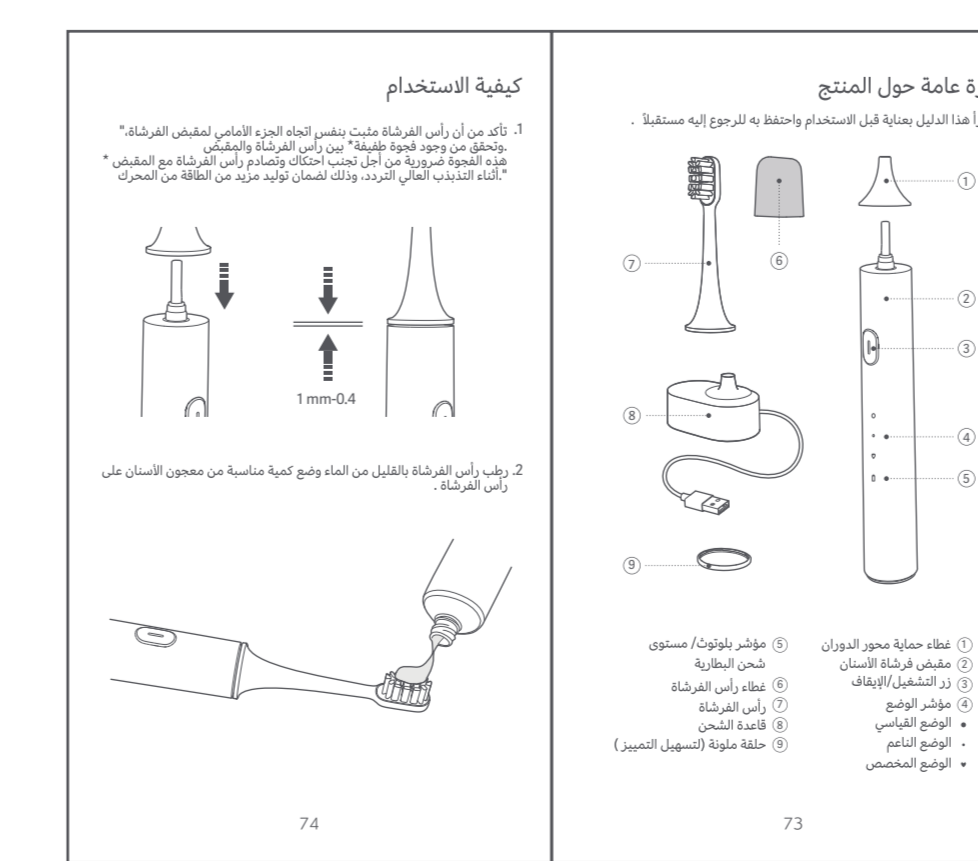
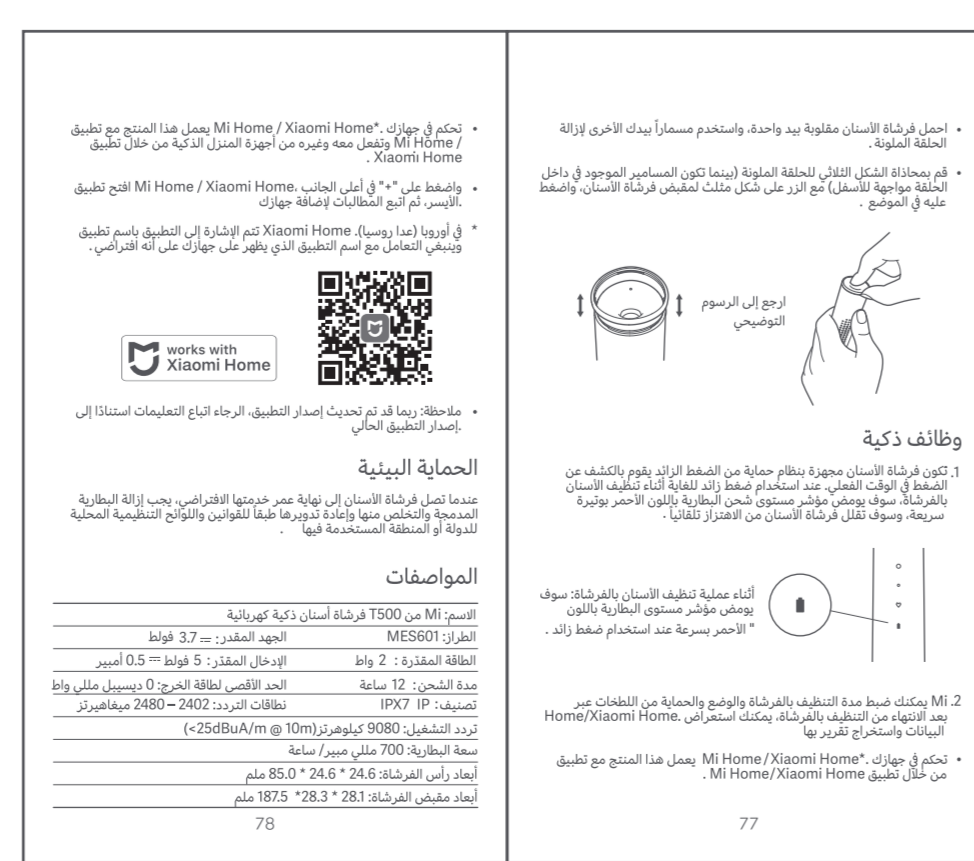
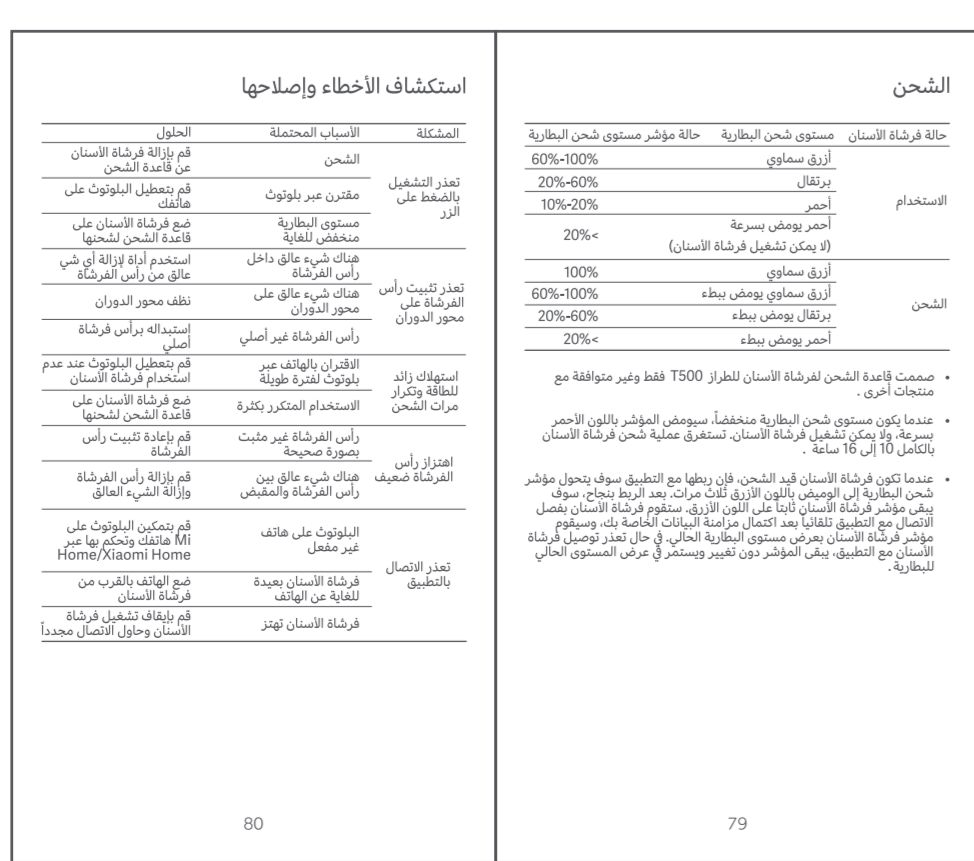

阿拉伯文正确

Mi Air Purifier 2S User Manual	01	英文 Adelle Sans Regelur
Manual de usuario de Mi Air Purifier 2S	13	西班牙文 Adelle Sans Regelur
Очиститель воздуха Mi 2S-руководство пользователя	23	俄罗斯文 Adelle Sans CYR Regelur
空気清浄機2Sユーザーマニュアル	33	日文 UD Gothic ML Regular
샤오미 미에어 2S 사용 설명서	43	韩文 UD Gothic ML Regular
Mi Air Purifier 2S - Benutzerhandbuch	53	德文 Adelle Sans Regelur
Mode d'emploi du Mi Air Purifier 2S	63	法文 Adelle Sans Regelur
مدخلت سمس لمي لرد Mi Air Purifier 2S	73	阿拉伯文 Adelle Sans ARA Regular